

LED High Bay Light

1. Product Feature

1. LED lights are high luminous efficacy and good energy efficiency. Compared with traditional incandescent, LED has high luminous efficacy of the system, is up to 90% energy-saving, saving more than 50% of conventional energy-saving lamps.

2. Using high quality SMD LED as lighting source, high brightness, long lifespan, low heat producing, LEDs have a general life expectancy of 50,000 hours.

3. LED lights brighten up immediately without preheating, instant start lighting; because of solid state source, LED lights are resistant to shock, vibrations and external impacts, convenient transportation and installation, high safety.

4. Excellent color rendering index, very close to nature light, can afford comfortable lighting; wide rang optional color temperatures, can be satisfied different requirements of condition illumination.

5. Large viewing angle, strong light emitting direction, LEDs are easy to control the light, can improve luminarie efficiency.

6. LED is environment protecting, no flash, low glare, completely eliminates eyes' fatigue, and has no mercury pollution. LED is the best choice of eco-friendly light source.

2. Product Specification

2.1 FN-GC201

1) Product Appearance:



2) Product Dimension Figure:

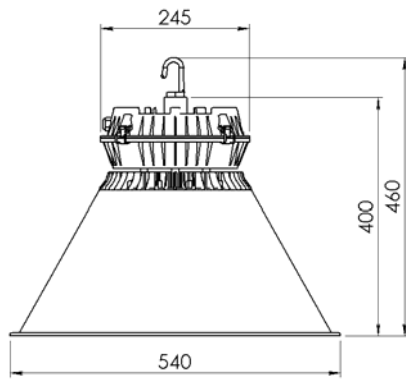

3) Light Distribution Curve

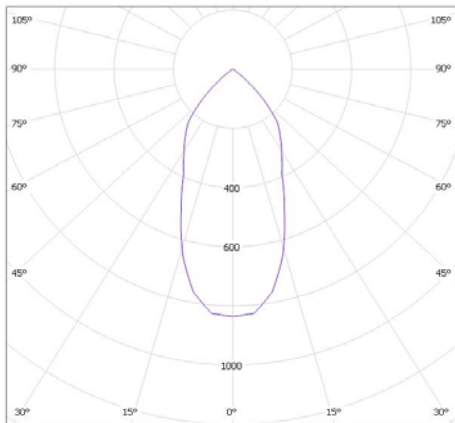

灯具: 常州富能电子有限公司 LED 100W LED 540
光源: 1 x

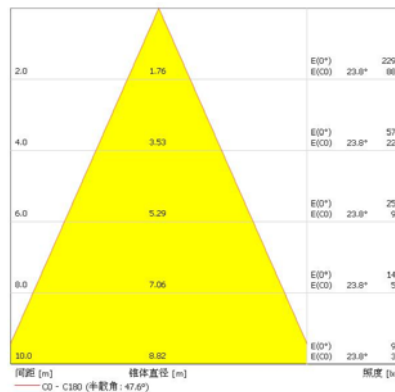

4) Basic Specification

Model Number	GC201-50W	GC201-80W	GC201-100W	GC201-120W
Power	50W	80W	100W	120W
Drive Circuit	Inbuilt Isolated Drive	Inbuilt Isolated Drive	Inbuilt Isolated Drive	Inbuilt Isolated Drive
Input Voltage	170V~240V AC 50-60Hz			
Power Factor	>0.9			
Efficiency	>85%			
Environment Temperature	-20~50°C			
Color Temperature	2700K-3000K/6000K-6800K			
Luminous Flux	≥5000lm	≥8000 lm	≥10000 lm	≥12000 lm
Lighting Effect	100 lm/w	100 lm/w	100 lm/w	100 lm/w
Irritation Angle	≥50°	≥50°	≥50°	≥50°
CRI	≥80	≥80	≥80	≥80

2.2 FN-GC202

1) Product Appearance:



2) Product Dimension Figure:

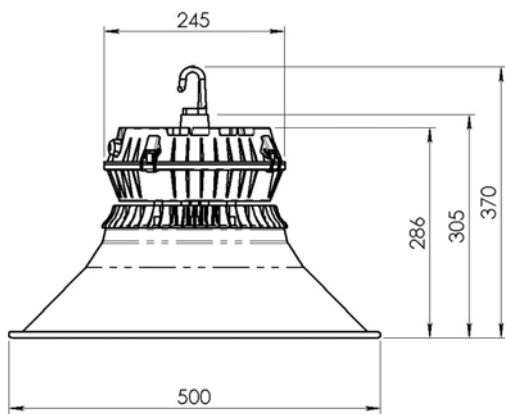

3) Light Distribution Curve

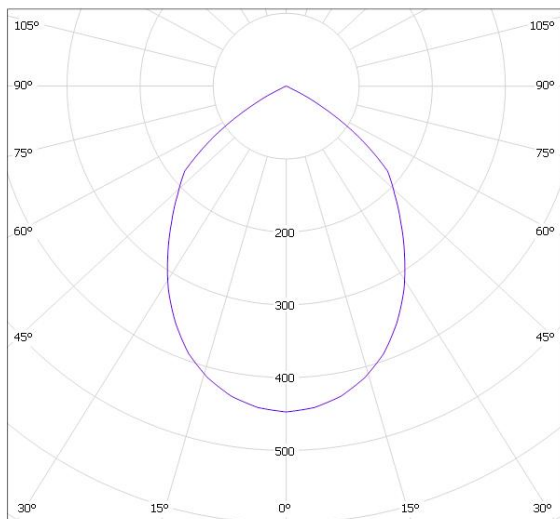

灯具：常州雷能电子有限公司 LED 100W LED 500-1
光源：1 x

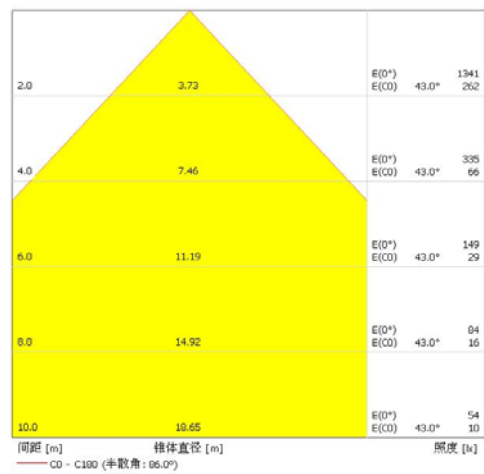

4) Basic Specification

Model Number	GC202-50W	GC202-80W	GC202-100W	GC202-120W
Power	50W	80W	100W	120W
Drive Circuit	Inbuilt Isolated Drive	Inbuilt Isolated Drive	Inbuilt Isolated Drive	Inbuilt Isolated Drive
Input Voltage	170V~240V AC 50-60Hz			
Power Factor	>0.9			
Efficiency	>85%			
Environment Temperature	-20~50°C			
Color Temperature	2700K-3000K/6000K-6800K			
Luminous Flux	≥5000lm	≥8000 lm	≥10000 lm	≥12000 lm
Lighting Effect	100 lm/w	100 lm/w	100 lm/w	100 lm/w
Irritation Angle	≥85°	≥85°	≥85°	≥85°
CRI	≥80	≥80	≥80	≥80

2.3 FN-GC221

1) Product Appearance:

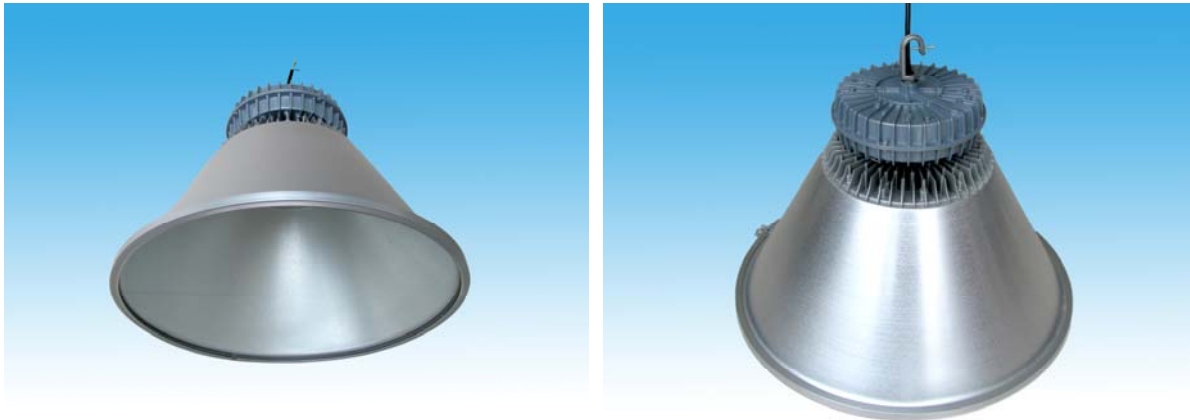

2) Product Dimension Figure:

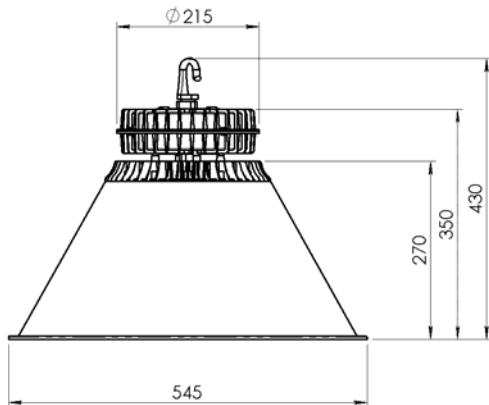

3) Light Distribution Curve

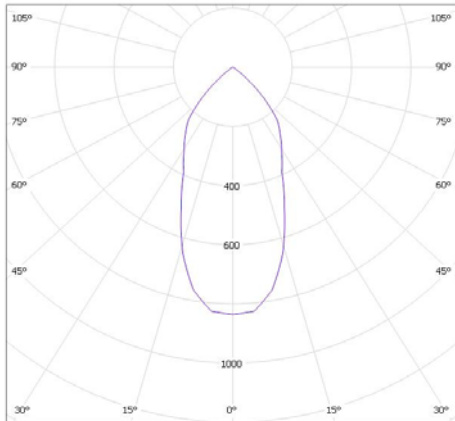

灯具: 常州富航电子有限公司 LED 100W LED 540
光源: 1 x

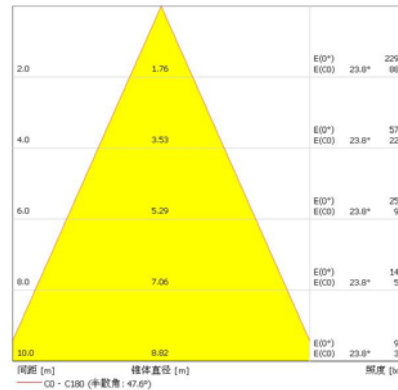

4) Basic Specification

Model Number	GC221-50W	GC221-80W	GC221-100W	GC221-120W
Power	50W	80W	100W	120W
Drive Circuit	Inbuilt Isolated Drive	Inbuilt Isolated Drive	Inbuilt Isolated Drive	Inbuilt Isolated Drive
Input Voltage	170V~240V AC 50-60Hz			
Power Factor	>0.9			
Efficiency	>85%			
Environment Temperature	-20~50°C			
Color Temperature	2700K-3000K/6000K-6800K			
Luminous Flux	≥5000lm	≥8000 lm	≥10000 lm	≥12000 lm
Lighting Effect	100 lm/w	100 lm/w	100 lm/w	100 lm/w
Irritation Angle	≥50°	≥50°	≥50°	≥50°
CRI	≥80	≥80	≥80	≥80

2.4 FN-GC222

1) Product Appearance:



2) Product Dimension Figure:

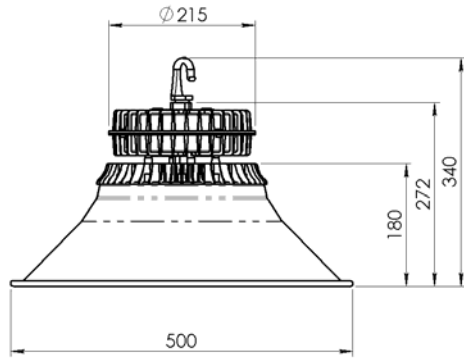

3) Light Distribution Curve 50W-100W

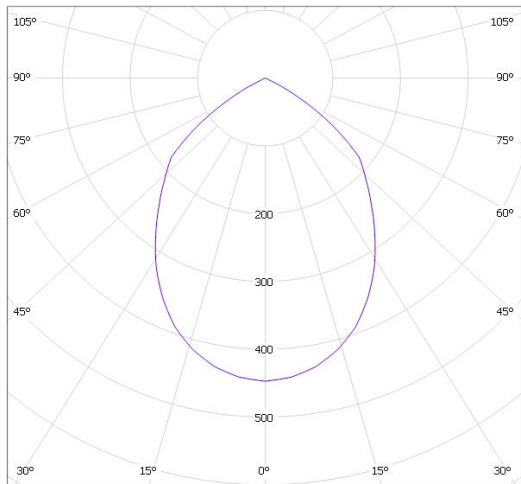

灯具: 常州富能电子有限公司 LED 100W LED 500-1
光源: 1 x

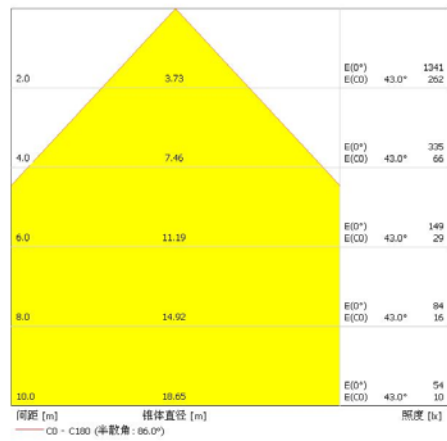

120W

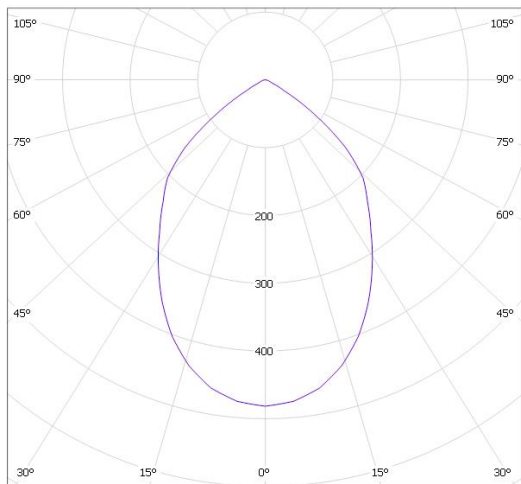

灯具: 常州富能电子有限公司 LED 100W LED 500-2
光源: 1 x

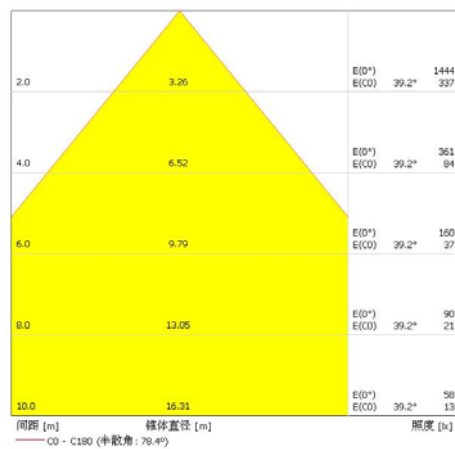

4) Basic Specification

Model Number	GC222-50W	GC222-80W	GC222-100W	GC222-120W
Power	50W	80W	100W	120W
Drive Circuit	Inbuilt Isolated Drive	Inbuilt Isolated Drive	Inbuilt Isolated Drive	Inbuilt Isolated Drive
Input Voltage	170V~240V AC 50-60Hz			
Power Factor	>0.9			
Efficiency	>85%			
Environment Temperature	-20~50°C			
Color Temperature	2700K-3000K/6000K-6800K			
Luminous Flux	≥5000lm	≥8000 lm	≥10000 lm	≥12000 lm
Lighting Effect	100 lm/w	100 lm/w	100 lm/w	100 lm/w
Irritation Angle	≥85°	≥85°	≥85°	≥85°
CRI	≥80	≥80	≥80	≥80

2.5 FN-GC223

1) Product Appearance:



2) Product Dimension Figure:

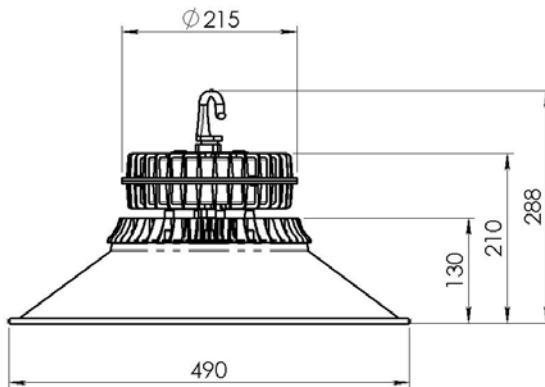

3) Light Distribution Curve

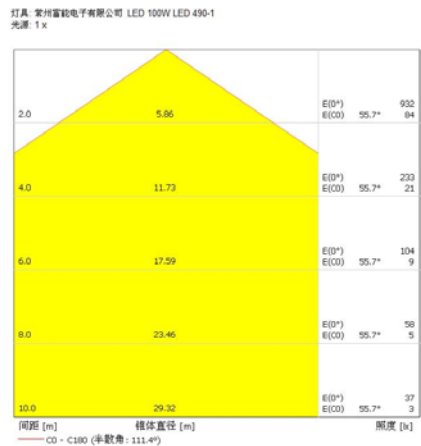
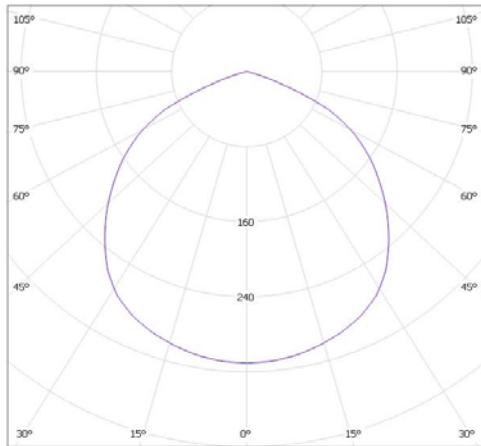

4) Basic Specification

Model Number	GC223-50W	GC223-80W	GC223-100W	GC223-120W
Power	50W	80W	100W	120W
Drive Circuit	Inbuilt Isolated Drive	Inbuilt Isolated Drive	Inbuilt Isolated Drive	Inbuilt Isolated Drive
Input Voltage	170V~240V AC 50-60Hz			
Power Factor	>0.9			
Efficiency	>85%			
Environment Temperature	-20~50℃			
Color Temperature	2700K-3000K/6000K-6800K			
Luminous Flux	≥5000lm	≥8000 lm	≥10000 lm	≥12000 lm
Lighting Effect	100 lm/w	100 lm/w	100 lm/w	100 lm/w
Irritation Angle	≥110°	≥110°	≥110°	≥110°
CRI	≥80	≥80	≥80	≥80

3. Safety: GB19510.14

Dielectric Strength: (Test Condition: Relative Humidity 70%, Leak Current 10mA)
2000V AC 1MIN No Flashover or Breakdown

EMC:

Conducted Interference: GB17743(EN 55015)
Radiated Interference: GB17743(EN 55015)
Harmonic Current: GB17625.1(EN 61000-3-2)

4. Environment Requirement

Working Temperature: -20°C~50°C

Stock and Transport Temperature: -40°C~55°C

Working Humidity: 10%~90%(40°C)

Stock and Transport Humidity: 10%~90%

Atmosphere Pressure: 86~106KPa

5. Instruction

1. LED lights rated voltage is AC170~240V 50/60Hz. Used under the condition of voltage too high or too low for a long term, will affect the function of normal use and service life.
2. Forbid to install in inflammable matter, whatever the situation, luminaire can't be covered with insulation blanket or something like that.
3. When install and exchange tube, must cut off the power to ensure personal safety.
4. LED high bay light is not suitable to use under dimming lighting places.
5. LED high bay light can't be watched directly with optical instrument. The grade is 1M.
6. When find the tube go abnormally (self-blackout, flash), please check the contact of lamp caps and holders, whether the power voltage is good. If they are all right, but the fault is still, you need to exchange new lamp.
7. This product only can be used indoor, forbid to use outside and the place getting wet in rain.